



D	Gebrauchsanweisung Einbauanweisung Im Fahrzeug mitzuführen!	Seite 2 Seite 6	NL	Gebruiksaanwijzing Inbouwhandleiding Im vertuig meenemen!	Pagina 40 Pagina 44				
>> GB	Operating instructions Installation instructions To be kept in the vehicle!	Page 11 Page 15	DK	Brugsanvisning Monteringsanvisning Skal medbringes i køretøjet!	Side 49 Side 53				
F	Mode d'emploi Instructions de montage À garder dans le véhicule !	Page 20 Page 25	E	Instrucciones de uso Instrucciones de montaje ¡Llévalas en el vehículo!	Página 58 Página 63				
I	Istruzioni per l'uso Istruzioni di montaggio Da tenere nel veicolo!	Pagina 30 Pagina 35	S	FIN	GR	CZ	SK	SLO	Page 72

Intended use

SecuMotion is a safety gas pressure regulation system for caravans and motor homes. The gas pressure regulation system provides an even output pressure of 30 mbar, with a permissible admission pressure of 0.3 – 16 bar.

A high-pressure hose with hose rupture protection (SBS) is essential for connecting the gas cylinder to the gas pressure regulation system. Truma provides the necessary high-pressure hoses with the most commonly-used connection variants for European gas cylinders (see pages 68 – 69).

SecuMotion regulates and monitors the consumption of liquid gas. If the specified consumption is exceeded or if the pressure at the regulator outlet falls below 27 mbar (due to a gas pipe break, for example), the integrated gas flow monitor will shut off the flow of gas.

The use of the gas pressure regulation system is **not** permitted in confined spaces (households, caravan holiday homes), on sea-going boats or in explosion protection zone 0 (e.g. tank trucks).

The integrated overpressure safety device complies with the requirements for a commercial safety device against excessively high pressure increases (for example, in Germany according to BGV D 34).



The pressure regulating devices and hoses must be replaced with new ones no more than 10 years after their date of manufacture (every 8 years if used commercially). This is the responsibility of the operator.

Notes on using the gas system while driving:

With motor homes as of construction year 01/2007, in accordance with the heating equipment directive 2001/56/EC with annexes 2004/78/EC and 2006/119/EC, a safety shut-off device must be provided for the operation of a liquid gas heater while driving that prevents gas from inadvertently escaping if a line breaks in the event of an

accident must be provided for operating while driving.

With an appropriately **designed gas installation** and in conjunction with **high-pressure gas hoses** with integrated hose rupture protection (SBS), Truma **SecuMotion** complies with all of the relevant standards, regulations and directives, and therefore **allows the gas system to be used while driving throughout Europe.**

We also recommend the use of a safety device for heating while driving in caravans.

For vehicles manufactured before 01/2007 there are no restrictions for operating the gas system while driving.*

* Exception for France:
In France the operation of the gas system while driving is only permitted in type-tested vehicles with initial registration as of 01.01.2007. In older vehicles the operation of the gas system while driving is non-permissible, even in combination with a safety shut-off device.

Gas cylinders that are not connected to the gas installation must be closed at all times and provided with protective caps. Connected gas cylinders are considered to be operating materials and not hazardous materials (ADR exemption in accordance with sections 1.1.3.1 and 1.1.3.2 e).

Operating instructions

The use of upright gas cylinders from which gas is **taken in the gas phase** is mandatory for the operation of the SecuMotion gas pressure regulation system. Gas cylinders from which gas is taken in the liquid phase (e.g. for fork lifts) must not be used, since they would result in damage to the gas system.

Taking into operation

Open gas remote switch if present.

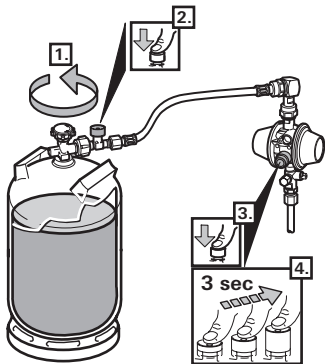

1. Open the cylinder's valve.
2. Firmly press the hose rupture protection device (green button) on the high pressure hose.

3. Press gas flow monitor reset button (green button) on gas pressure regulation system **slowly**.

4. Release gas flow monitor reset button (green button) on gas pressure regulation system **slowly** (3 seconds).

If no pressure point is felt when the button is pressed again, the gas pressure regulation system is ready for operation (repeat procedure if necessary).

Start the gas-burning devices if desired.

If the gas cylinders are closed, SecuMotion may switch off after an extended period of no usage.

Changing a gas cylinder

Please use the included screwing tool to attach and remove the high pressure hoses. It will help you generate the necessary tightening torque and will prevent damage to the screw fittings, which may otherwise result from using an improper tool.



Residual gas: No smoking!
No open flames!

- Close the empty gas cylinder's valve.
- Unscrew the high pressure hose from the gas cylinder and remove the clip-on adapter, if present.
- Screw the high pressure hose to the full gas cylinder and apply the clip-on adapter, if present.
- Open the full cylinder's valve.

- Press the hose rupture protection device and the gas-flow monitor (see “Taking into operation”).

 Anytime after making changes, check the hose connection to the cylinder valve for leaks (see “Checking for leaks in the high pressure area”).

Exchanging hoses

Please use the included screwing tool to attach and remove the high pressure hoses. It will help you generate the necessary tightening torque and will prevent damage to the screw fittings, which may otherwise result from using an improper tool.

 Residual gas: No smoking! No open flames!

- Close the gas cylinder’s valve.
- Unscrew the high pressure hose from the gas cylinder (or from the clip-on adapter) and from the gas pressure regulation system inlet.



When performing a hose change, please ensure that the gasket provided with the hose (hose outlet – gas pressure regulation system inlet) is correctly installed and undamaged.



We recommend that the gasket (part no. 50020-76300) be replaced with every hose change.

- Screw country-specific high-pressure hose to SecuMotion inlet and cylinder (or to clip-on adapter).

- Open the gas cylinder’s valve.
- Press the hose rupture protection device and, if necessary, the gas-flow monitor (see “Taking into operation”).

Anytime after making changes, check the hose connections to the cylinder valve and to the inlet of the SecuMotion gas pressure regulation system for leaks (see “Checking for leaks in the high pressure area”).

Checking for leaks in the high pressure area



A trained technician must check the low pressure area for leaks. In addition, we recommend that the person responsible for operating the gas system check the high pressure area for leaks after every cylinder or hose replacement.

In particular, the screw fittings on the gas cylinder valve and on the gas pressure regulation system inlet should be checked for leaks with the proper tools, such as a leak-finder spray according to DIN EN 14291.

Hochdruck-Schlauch / High pressure hose / Lyre haute pression**Verwendung nach Ländern / Use in countries / Utilisation spécifique pays**

	A	B	CH	CY	CZ	D	DK	E	F	FIN	GB	GR	HR	H	I	IRL
G.1 50410-04 50420-04				●								●			●	
G.2 50410-03 50420-03		○	●		○		○	○	●				○	○		
G.7 50410-02 50420-02											● propane					● butane
G.8 50410-06 50420-06		●			●		●	●	○		● butane		●	●		● propane
G.10 50410-05 50420-05																
G.12 50410-01 50420-01	●					●	○			●						

● = Gängigster Anschluss / Most common connection / Raccordement le plus courant

○ = Ebenfalls erhältliche Anschlüsse / Also available connections / Raccordement également disponibles

Art-Nr. / part no. / N° d'art.: 50410-xx (450 mm)

50420-xx (750 mm)

Hochdruck-Schlauch / High pressure hose / Lyre haute pression
Verwendung nach Ländern / Use in countries / Utilisation spécifique pays

	(IS)	(L)	(M)	(N)	(NL)	(P)	(PL)	(S)	(SK)	(SLO)	(TR)	(YU)	
G.1 50410-04 50420-04			●								●		
G.2 50410-03 50420-03	○	○			○		○		○	○		○	
G.7 50410-02 50420-02													
G.8 50410-06 50420-06	○	●		x	●				●	●		●	
G.10 50410-05 50420-05	●			●		●		●					
G.12 50410-01 50420-01					○		●						

- = Gängigster Anschluss / Most common connection / Raccordement le plus courant
- = Ebenfalls erhältliche Anschlüsse / Also available connections / Raccordement également disponibles
- x = für Gasflaschen mit Clip-on Adapter / for gas cylinders with clip-on adapter / pour bouteilles avec adaptateur à clipser

Art-Nr. / part no. / N° d'art.: 50410-xx (450 mm)
 50420-xx (750 mm)

- S** Bruks- och monteringsanvisningar på svenska kan rekvireras från tillverkaren Truma eller från Truma Service i Sverige.
- FIN** Käyttö- ja asennusohjeita on saatavissa Trumavalmistajalta tai Truma huollosta.
- GR** Οι οδηγίες χρήσης και τοποθέτησης στη γλώσσα της χώρας σας μπορούν να ζητηθούν από την κατασκευάστρια εταιρία Truma ή το Truma Σέρβις στη χώρα σας.
- CZ** Návod k použití a montážní návod si lze v řeči Vaší země vyžádat u výrobce Truma nebo servisu Truma ve Vaší zemi.
- SK** Návod na montáž a návod na použitie si môžete vyžiadať vo Vašom jazyku u výrobcu Truma alebo v Trumaservise vo Vašej krajine.
- SLO** Navodilo za uporabo in vgradnjo v svojem državnem jeziku lahko naročite pri proizvajalcu Truma ali pri servisni službi Truma v vaši državi.

Truma Gerätetechnik
GmbH & Co. KG
Wernher-von-Braun-Straße 12
85640 Putzbrunn
Deutschland

Service

Telefon +49 (0)89 4617-2142
Telefax +49 (0)89 4617-2159

service@truma.com
www.truma.com